

M25 Light Cover

IPX7

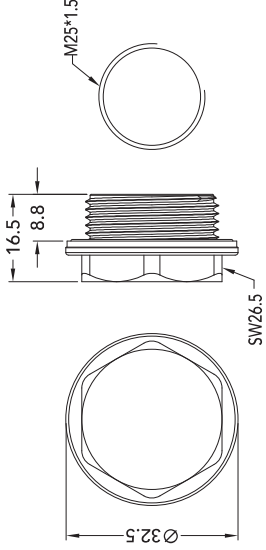

- Features and Benefits**
- Temperature Range -40°C ~105°C
 - Material PC Transparent
 - Configurable & customizable



Part Number	Color	Panel Thickness	Description
CUMPLUGS73	Transparent	min. 3.0mm	Without Panel Nut (Screw M25xP1.5)

M25 Light Cover With Panel Nut

IPX7



- Features and Benefits**
- Temperature Range -40°C ~105°C
 - Material PC Transparent
 - Configurable & customizable
 - With Panel Nut

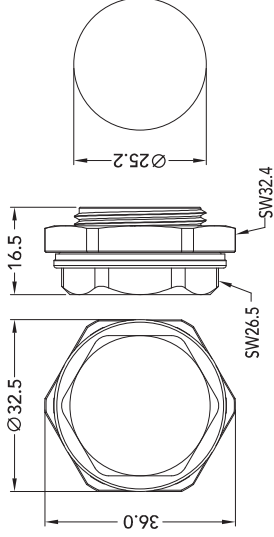

Part Number	Color	Panel Thickness	Description
CUMPLUGS7A	Transparent	Max. 3.0mm	With Panel Nut (Screw M25xP1.5)