



D-SUB

SERIES

D-SUB Receptacle

PCB LAYOUT D-SUB 9PIN

Male Connector
Male Pin
&
Female Connector
Female Pin

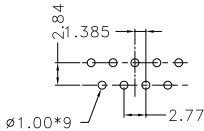

Current 5A

PCB LAYOUT D-SUB 15PIN

Male Connector
Male Pin
&
Female Connector
Female Pin

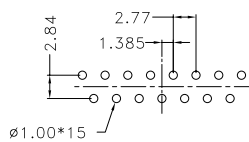

Current 5A

PCB LAYOUT HD-SUB 15PIN

Male Connector
&
Male Pin

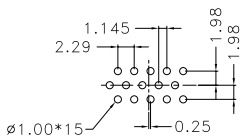

Current 2A

Female Connector
&
Female Pin

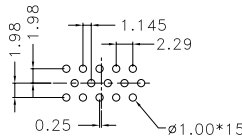

Current 2A

PCB LAYOUT HD-SUB 26PIN

Male Connector
&
Male Pin

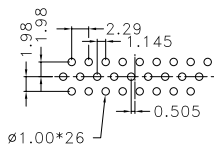

Current 2A

Female Connector
&
Female Pin

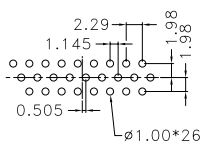

Current 2A

D-SUB

Product Specifications

General Data

Number of Positions	9P & 15P
Housing	Nylon+GF or ABS
Shell	Steel, Nickel & Tin Finished
Terminal	Copper Alloy, Gold Plated

Electrical Data

Current Rating	5A
Contact Resistance	≤ 20mΩ
Insulation Resistance	≥ 100MΩ at DC 500V
Withstanding Voltage	AC 500V/1 Minute
Standard	MIL-DTL-24308G

Environmental Data

Mating Style	Screw Thread
Max Panel Thickness	1.2~2.0mm
Temperature Range	Panel Type -40℃ ~ +105℃ Cable Type -20℃ ~ +80℃
Salt Spray	48 hr.
Protection Class	Panel Type IPX8 (Unmated) Cable Type IPX7 (Mated)
Durability	500 Times

How to Order

DBDPX XX XCC - SSX8XXX

Connector Style
F - Female
M - Male

Number of Contacts
09, 15

Contact Type
F - Female
M - Male

Serial Number

Assembly Style
S - Solder Type
P - PCB Type
R - Right Angle PCB Type
A - Board Lock Straight PCB Type
B - Board Lock Right Angle PCB Type

DBDAX XX XCC - SLC7XXX

Connector Style
F - Female
M - Male

Number of Contacts
09, 15

Contact Type
F - Female
M - Male

Cable Type / Length (M)
A01~A99

D-SUB High Density

Product Specifications

General Data

Number of Positions	15P & 26P
Housing	Nylon+GF or ABS
Shell	Steel, Nickel & Tin Finished
Terminal	Copper Alloy, Gold Plated

Electrical Data

Current Rating	2A
Contact Resistance	≤ 20mΩ
Insulation Resistance	≥ 100MΩ at DC 500V
Withstanding Voltage	AC 500V/1 Minute
Standard	MIL-DTL-24308G

Environmental Data

Mating Style	Screw Thread
Max Panel Thickness	1.2~2.0mm
Temperature Range	Panel Type -40℃ ~ +105℃ Cable Type -20℃ ~ +80℃
Salt Spray	48 hr.
Protection Class	Panel Type IPX8 (Unmated) Cable Type IPX7 (Mated)
Durability	500 Times

How to Order

DBHPX XX XBB - SSX8XXX

Connector Style
F - Female
M - Male

Number of Contacts
15, 26

Contact Type
F - Female
M - Male

Assembly Style
S - Solder Type
P - PCB Type
R - Right Angle PCB Type
A - Board Lock Straight PCB Type
B - Board Lock Right Angle PCB Type

Serial Number

DBHAX XX XBB - SLC7XXX

Connector Style
F - Female
M - Male

Number of Contacts
15, 26

Contact Type
F - Female
M - Male

Cable Type / Length (M)
A01~A99

D-SUB Receptacle (Plastic) Front Fastened, IPX8

Features and Benefits

- Female Connector, Female Pin
- Standard D-Sub 9P Receptacle
- Assembly type available in Solder, PCB, Straight and Angled
- Shielded shell for high noise immunity
- Up to 500 mating cycles
- Configurable & customizable

Part Number	Contact	Current	Voltage	Ass'y Type
DBDPF09FCC-SSA8001	9Pin	5A	30V	Board Lock 180°
DBDPF09FCC-SSB8001	9Pin	5A	30V	Board Lock 90°
DBDPF09FCC-SSP8001	9Pin	5A	30V	PCB Straight

Part Number	Contact	Current	Voltage	Ass'y Type
DBDPF09FCC-SSR8001	9Pin	5A	30V	PCB Right Angle
DBDPF09FCC-SSS8001	9Pin	5A	30V	Solder

D-SUB Receptacle (Plastic) Front Fastened, IPX8

Features and Benefits

- Male Connector, Male Pin
- Standard D-Sub 9P Receptacle
- Assembly type available in Solder, PCB, Straight and Angled
- Shielded shell for high noise immunity
- Up to 500 mating cycles
- Configurable & customizable

Part Number	Contact	Current	Voltage	Ass'y Type
DBDPM09MCC-SSA8001	9Pin	5A	30V	Board Lock 180°
DBDPM09MCC-SSB8001	9Pin	5A	30V	Board Lock 90°
DBDPM09MCC-SSP8001	9Pin	5A	30V	PCB Straight

Part Number	Contact	Current	Voltage	Ass'y Type
DBDPM09MCC-SSR8001	9Pin	5A	30V	PCB Right Angle
DBDPM09MCC-SSS8001	9Pin	5A	30V	Solder

❁ D-SUB Cable Assembly (Plastic) Straight, IPX7

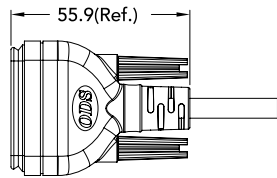
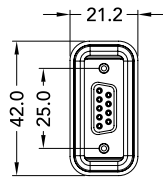

Features and Benefits

- Female Connector, Female Pin
- Standard D-Sub 9P Cable Overmolding
- Shielded shell for high noise immunity
- Up to 500 mating cycles
- Configurable & customizable

Part Number	Contact	Current	Voltage	Ass'y Type
DBDAF09FCC-SLC7AXX	9Pin	5A	30V	Cable End Cut

❁ D-SUB Cable Assembly (Plastic) Straight, IPX7

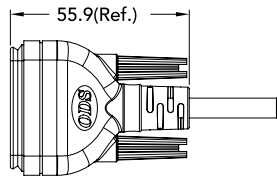
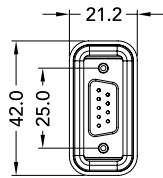

Features and Benefits

- Male Connector, Male Pin
- Standard D-Sub 9P Cable Overmolding
- Shielded shell for high noise immunity
- Up to 500 mating cycles
- Configurable & customizable

Part Number	Contact	Current	Voltage	Ass'y Type
DBDAM09MCC-SLC7AXX	9Pin	5A	30V	Cable End Cut

❁ D-SUB Receptacle (Plastic) Front Fastened, IPX8

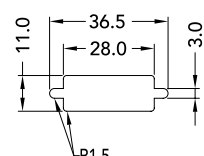
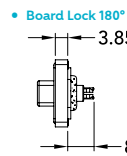
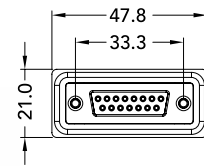

Features and Benefits

- Female Connector, Female Pin
- Standard D-Sub 15P Receptacle
- Assembly type available in Solder, PCB, Straight and Angled
- Shielded shell for high noise immunity
- Up to 500 mating cycles
- Configurable & customizable

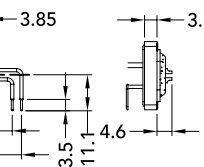
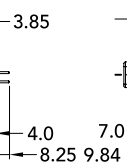
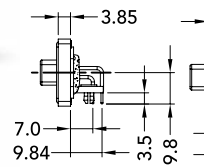

Part Number	Contact	Current	Voltage	Ass'y Type
DBDPPF15FCC-SSA8001	15Pin	5A	30V	Board Lock 180°
DBDPPF15FCC-SSB8001	15Pin	5A	30V	Board Lock 90°
DBDPPF15FCC-SSP8001	15Pin	5A	30V	PCB Straight

Part Number	Contact	Current	Voltage	Ass'y Type
DBDPPF15FCC-SSR8001	15Pin	5A	30V	PCB Right Angle
DBDPPF15FCC-SSS8001	15Pin	5A	30V	Solder

❁ D-SUB Receptacle (Plastic) Front Fastened, IPX8

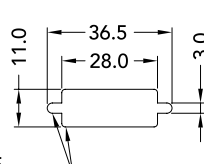
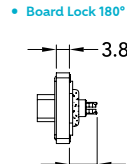
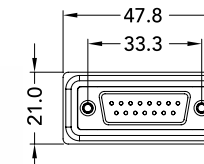
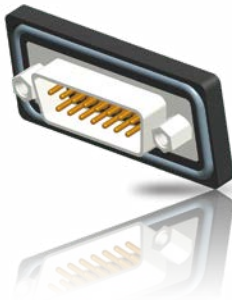

Features and Benefits

- Male Connector, Male Pin
- Standard D-Sub 15P Receptacle
- Assembly type available in Solder, PCB, Straight and Angled
- Shielded shell for high noise immunity
- Up to 500 mating cycles
- Configurable & customizable

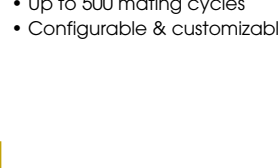
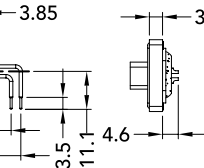
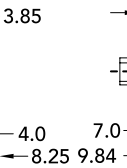
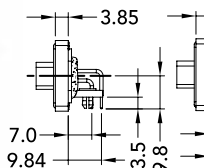

Part Number	Contact	Current	Voltage	Ass'y Type
DBDPM15MCC-SSA8001	15Pin	5A	30V	Board Lock 180°
DBDPM15MCC-SSB8001	15Pin	5A	30V	Board Lock 90°
DBDPM15MCC-SSP8001	15Pin	5A	30V	PCB Straight

Part Number	Contact	Current	Voltage	Ass'y Type
DBDPM15MCC-SSR8001	15Pin	5A	30V	PCB Right Angle
DBDPM15MCC-SSS8001	15Pin	5A	30V	Solder

D-SUB Cable Assembly (Plastic) Straight, IPX7

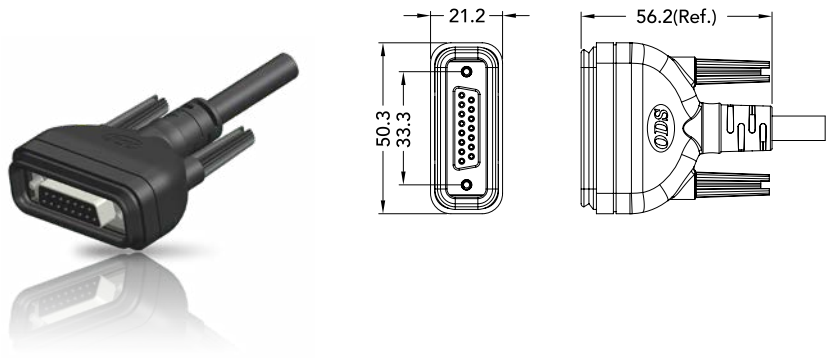

Features and Benefits

- Female Connector, Female Pin
- Standard D-Sub 15P Cable Overmolding
- Shielded shell for high noise immunity
- Up to 500 mating cycles
- Configurable & customizable

Part Number	Contact	Current	Voltage	Ass'y Type
DBDAF15FCC-SLC7AXX	15Pin	5A	30V	Cable End Cut

D-SUB Cable Assembly (Plastic) Straight, IPX7

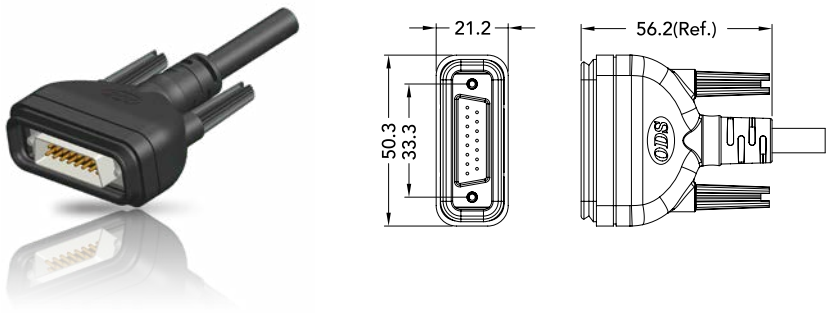

Features and Benefits

- Male Connector, Male Pin
- Standard D-Sub 15P Cable Overmolding
- Shielded shell for high noise immunity
- Up to 500 mating cycles
- Configurable & customizable

Part Number	Contact	Current	Voltage	Ass'y Type
DBDAM15MCC-SLC7AXX	15Pin	5A	30V	Cable End Cut

D-SUB High Density Receptacle (Plastic) Front Fastened, IPX8

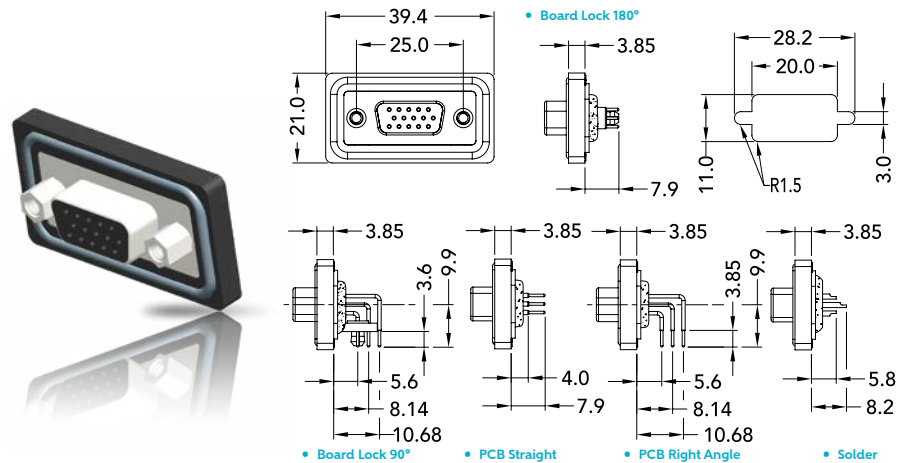

Features and Benefits

- Female Connector, Female Pin
- High Density D-Sub 15P Receptacle
- Assembly type available in Solder, PCB, Straight and Angled
- Shielded shell for high noise immunity
- Up to 500 mating cycles
- Configurable & customizable

Part Number	Contact	Current	Voltage	Ass'y Type
DBHPPF15FBB-SSA8001	15Pin	2A	30V	Board Lock 180°
DBHPPF15FBB-SSB8001	15Pin	2A	30V	Board Lock 90°
DBHPPF15FBB-SSP8001	15Pin	2A	30V	PCB Straight

Part Number	Contact	Current	Voltage	Ass'y Type
DBHPPF15FBB-SSR8001	15Pin	2A	30V	PCB Right Angle
DBHPPF15FBB-SSS8001	15Pin	2A	30V	Solder

D-SUB High Density Receptacle (Plastic) Front Fastened, IPX8

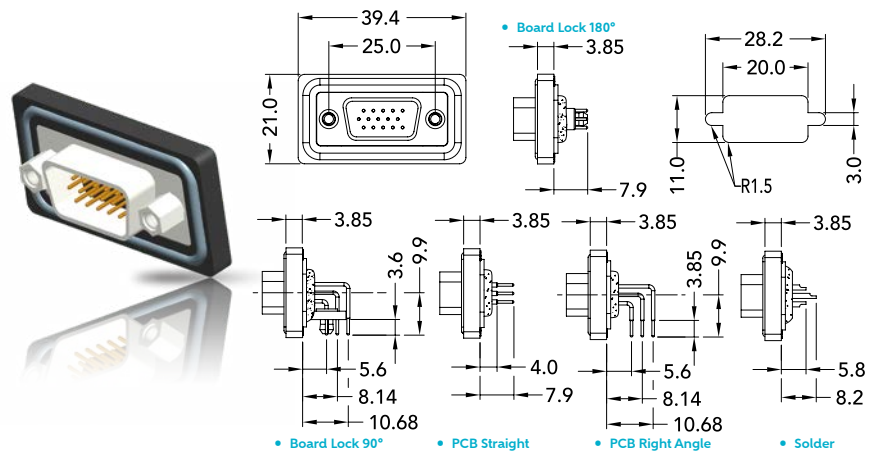

Features and Benefits

- Male Connector, Male Pin
- High Density D-Sub 15P Receptacle
- Assembly type available in Solder, PCB, Straight and Angled
- Shielded shell for high noise immunity
- Up to 500 mating cycles
- Configurable & customizable

Part Number	Contact	Current	Voltage	Ass'y Type
DBHPM15MBB-SSA8001	15Pin	2A	30V	Board Lock 180°
DBHPM15MBB-SSB8001	15Pin	2A	30V	Board Lock 90°
DBHPM15MBB-SSP8001	15Pin	2A	30V	PCB Straight

Part Number	Contact	Current	Voltage	Ass'y Type
DBHPM15MBB-SSR8001	15Pin	2A	30V	PCB Right Angle
DBHPM15MBB-SSS8001	15Pin	2A	30V	Solder

D-SUB High Density Cable Assembly (Plastic) Straight, IPX7

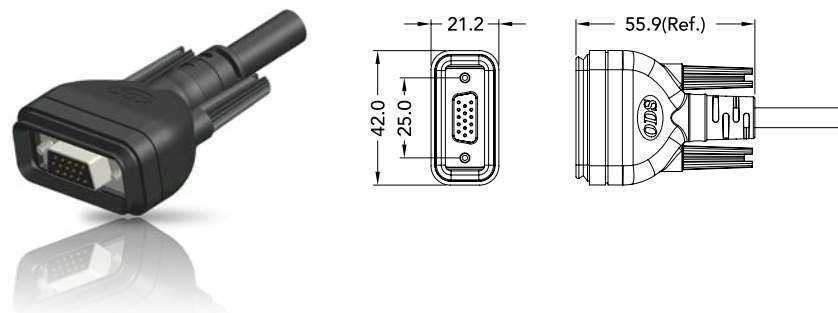

Features and Benefits

- **Female Connector, Female Pin**
- High Density D-Sub 15P Cable Overmolding
- Shielded shell for high noise immunity
- Up to 500 mating cycles
- Configurable & customizable

Part Number	Contact	Current	Voltage	Ass'y Type
DBHAF15FBB-SLC7AXX	15Pin	2A	30V	Cable End Cut

D-SUB High Density Cable Assembly (Plastic) Straight, IPX7

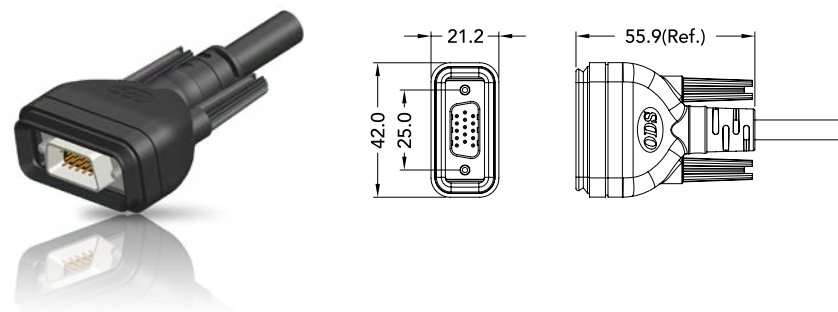

Features and Benefits

- **Male Connector, Male Pin**
- High Density D-Sub 15P Cable Overmolding
- Shielded shell for high noise immunity
- Up to 500 mating cycles
- Configurable & customizable

Part Number	Contact	Current	Voltage	Ass'y Type
DBHAM15MBB-SLC7AXX	15Pin	2A	30V	Cable End Cut

D-SUB High Density Receptacle (Plastic) Front Fastened, IPX8

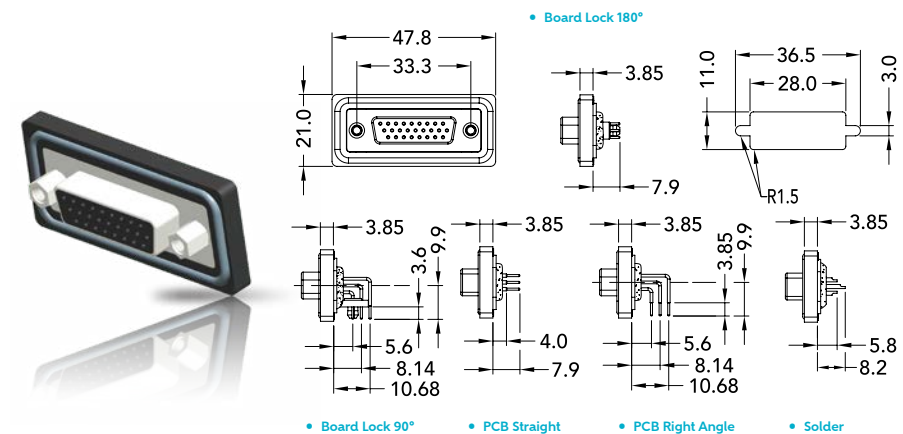

Features and Benefits

- **Female Connector, Female Pin**
- High Density D-Sub 26P Receptacle
- Assembly type available in Solder, PCB, Straight and Angled
- Shielded shell for high noise immunity
- Up to 500 mating cycles
- Configurable & customizable

Part Number	Contact	Current	Voltage	Ass'y Type
DBHPF26FBB-SSA8001	26Pin	2A	30V	Board Lock 180°
DBHPF26FBB-SSB8001	26Pin	2A	30V	Board Lock 90°
DBHPF26FBB-SSP8001	26Pin	2A	30V	PCB Straight

Part Number	Contact	Current	Voltage	Ass'y Type
DBHPPF26FBB-SSR8001	26Pin	2A	30V	PCB Right Angle
DBHPPF26FBB-SSS8001	26Pin	2A	30V	Solder

D-SUB High Density Receptacle (Plastic) Front Fastened, IPX8

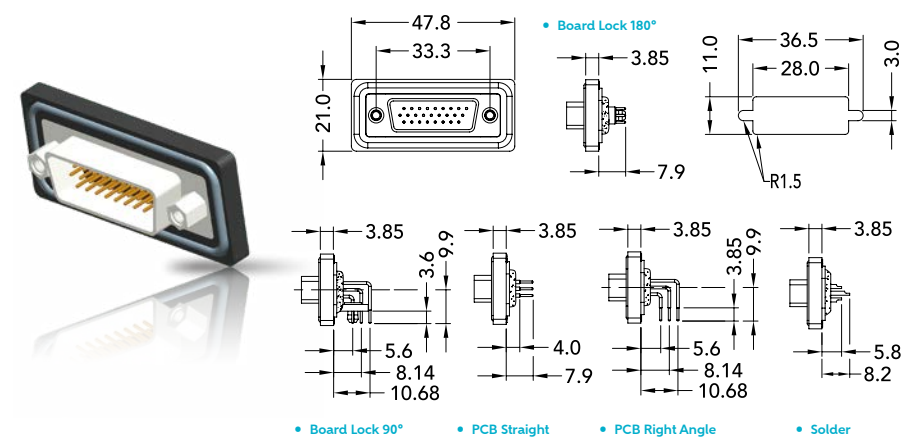

Features and Benefits

- **Male Connector, Male Pin**
- High Density D-Sub 26P Receptacle
- Assembly type available in Solder, PCB, Straight and Angled
- Shielded shell for high noise immunity
- Up to 500 mating cycles
- Configurable & customizable

Part Number	Contact	Current	Voltage	Ass'y Type
DBHPM26MBB-SSA8001	26Pin	2A	30V	Board Lock 180°
DBHPM26MBB-SSB8001	26Pin	2A	30V	Board Lock 90°
DBHPM26MBB-SSP8001	26Pin	2A	30V	PCB Straight

Part Number	Contact	Current	Voltage	Ass'y Type
DBHPM26MBB-SSR8001	26Pin	2A	30V	PCB Right Angle
DBHPM26MBB-SSS8001	26Pin	2A	30V	Solder

❖ D-SUB High Density Cable Assembly (Plastic) Straight, IPX7

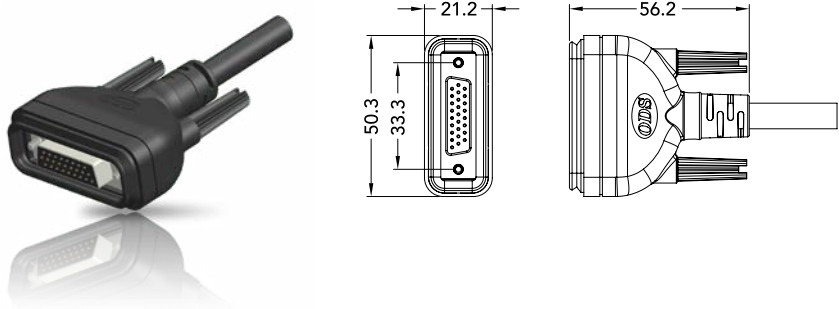

- Features and Benefits
- Female Connector, Female Pin
 - High Density D-Sub 26P Cable Overmolding
 - Shielded shell for high noise immunity
 - Up to 500 mating cycles
 - Configurable & customizable

Part Number	Contact	Current	Voltage	Ass'y Type
DBHAF26FBB-SLC7AXX	26Pin	2A	30V	Cable End Cut

❖ D-SUB High Density Cable Assembly (Plastic) Straight, IPX7

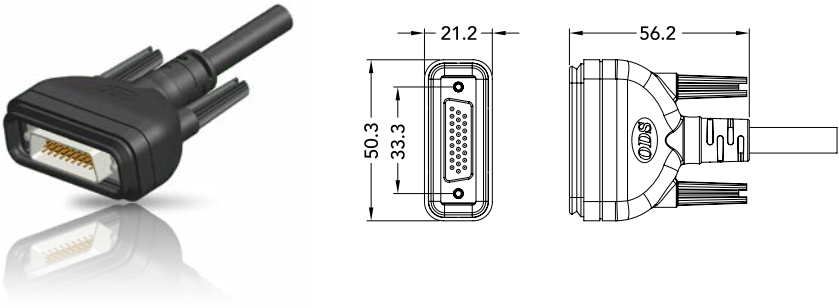

- Features and Benefits
- Male Connector, Male Pin
 - High Density D-Sub 26P Cable Overmolding
 - Shielded shell for high noise immunity
 - Up to 500 mating cycles
 - Configurable & customizable

Part Number	Contact	Current	Voltage	Ass'y Type
DBHAM26MBB-SLC7AXX	26Pin	2A	30V	Cable End Cut

❖ D-SUB Accessory Cap IPX7 (Mated)

- Features and Benefits
- One sealing surface means less likelihood of failure
 - Maintains IPX7 rating for functional integrity when connector is not mated
 - IPX7 ratings ensures cable assemblies are water and dust tight for functional integrity

Part Number	Size	Description	Part Number	Size	Description
CPSP1UGSM71	D-SUB Size 1	Female Plastic Screw Lock Cap, With Metal Chain	CPSP1UGSN71	D-SUB Size 1	Female Plastic Screw Lock Cap



